

# the COZUMEL

Plan OR3

SKY  
TERRACE  
COLLECTION



1750 SQ. FEET  
3-BEDROOM | 2.5 BATH  
2-CAR GARAGE  
ROOF TERRACE

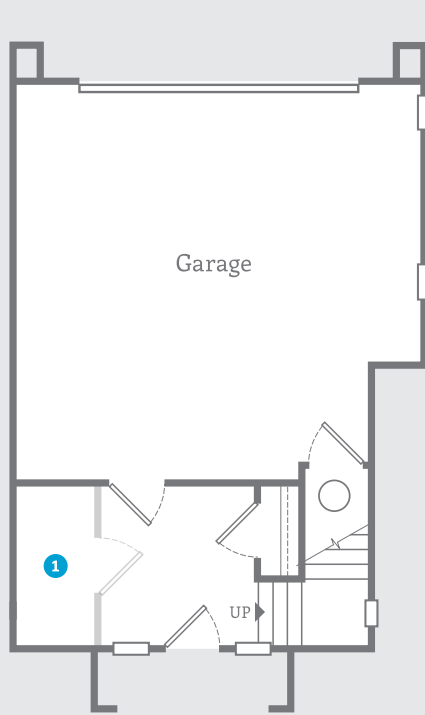

First Floor

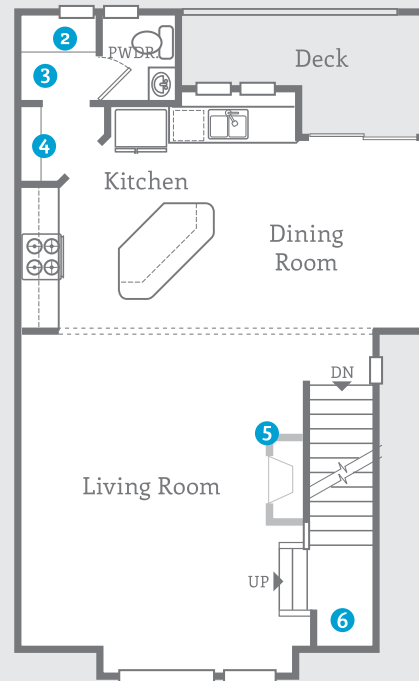

Second Floor

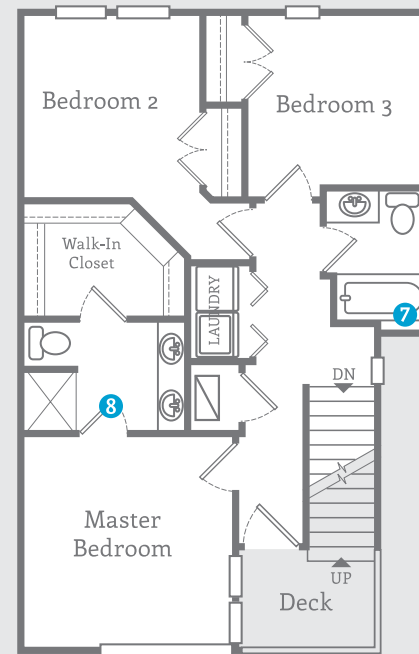

Third Floor

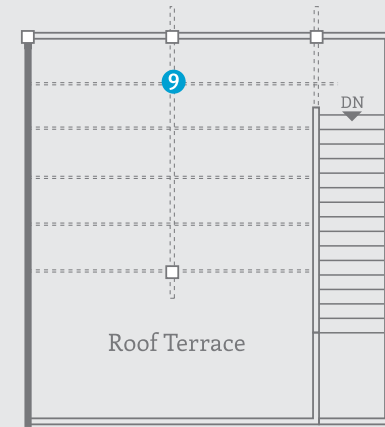

Fourth Floor

- 1 Optional Storage Room
- 2 Optional Desk
- 3 Optional Pantry With Double Doors
- 4 Standard 12" Lower Cabinets With Counter Top • Optional Upper Cabinets
- 5 Optional Fireplace

- 6 Optional Shelves
- 7 Optional Shelf
- 8 Standard Single Door  
Optional Split Doors  
Swinging Into Bedroom
- 9 Optional Pergola

This is only a conceptual, artistic rendering of the floor plan. Actual dimensions, square footage, and locations of windows, decks, patios and other features will vary from building to building. Refer to the architectural construction drawings for more detail.