

# MLR Plan

- 1 Optional Elevator
- 2 Optional Bedroom/Bathroom
- 3 Included Lower Cabinets w/Countertops  
Optional Upper Cabinets
- 4 Opt. Wall Oven
- 5 Opt. Linen Shelves or Cabinets
- 6 Included Four Panel Double Slider Patio Doors

**2493 SQ. FT.**  
3 or 4 BEDROOMS  
2.5 BATHS  
2-CAR GARAGE

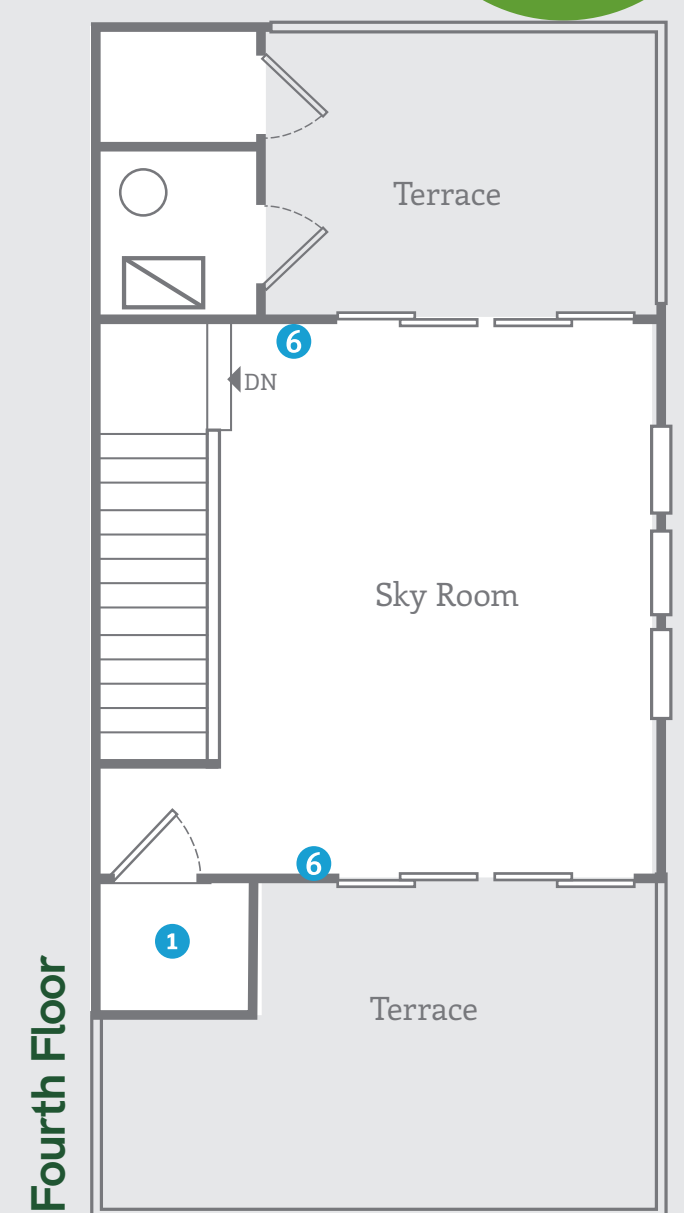
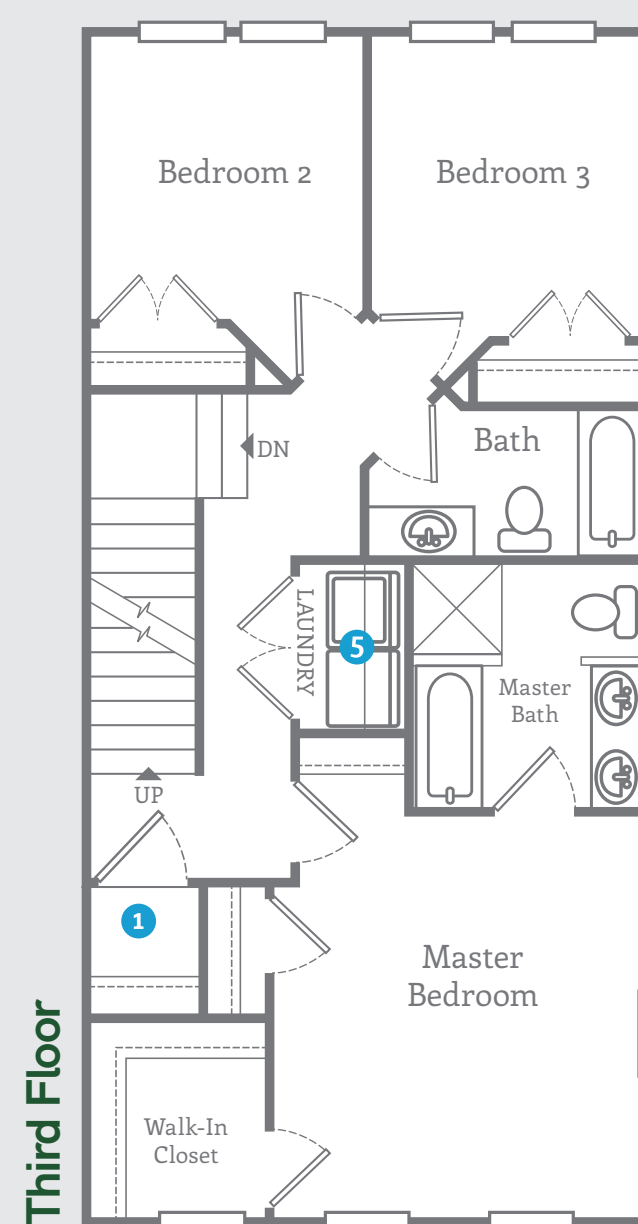
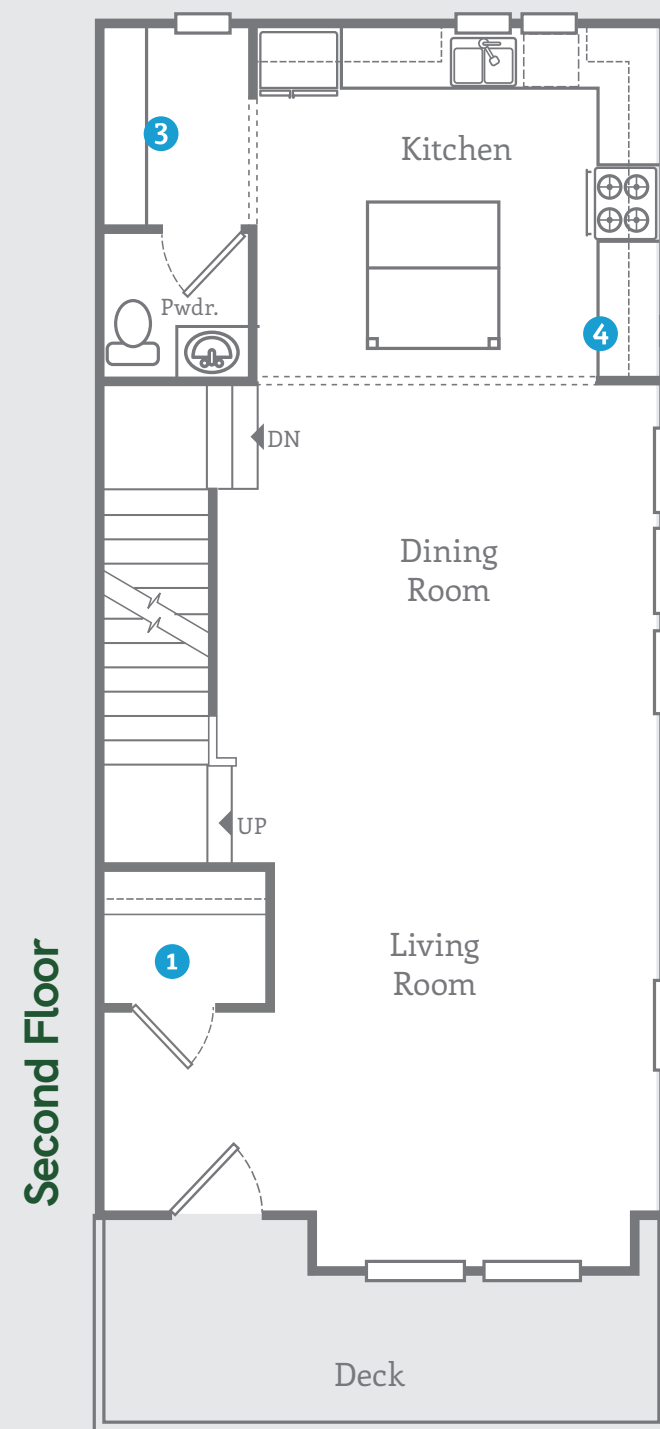
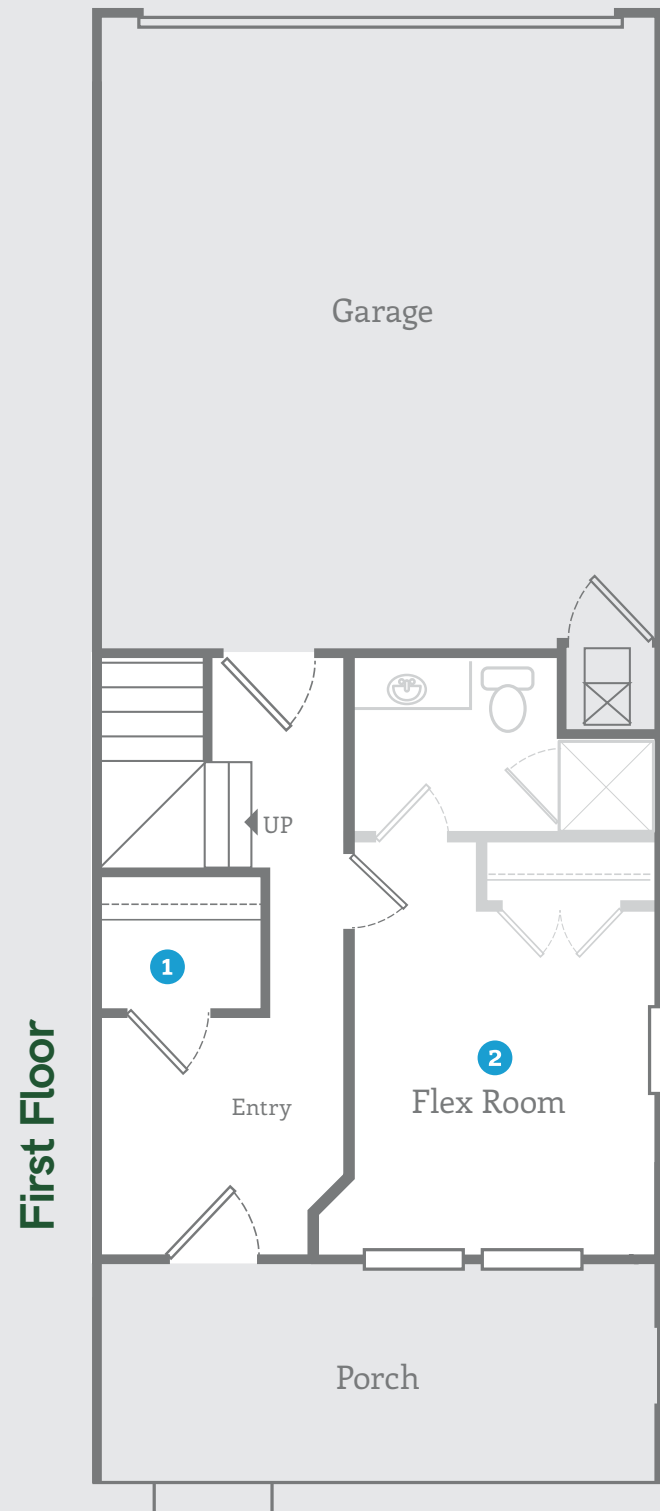

This is only a conceptual, artistic rendering of the floor plan. Actual dimensions, square footage, and locations of windows, decks, patios and other features will vary from building to building. Refer to the architectural construction drawings for more detail.